

680 Rhode Island Ave, NE

Washington DC

PUD Application

© 2015 SK&I Architectural Design Group, LLC.



PROPERTY OWNER
B + R Associates LP

DEVELOPMENT TEAM

DEVELOPER / APPLICANT
MRP Rhode Island Avenue Investors LLC

LAND USE COUNSEL
Goulston & Storrs

ARCHITECT
SK&I Architectural Design Group, LLC

CIVIL ENGINEER
Bowman Consulting

TRAFFIC CONSULTANT
Gorve / Slade

LANDSCAPE ARCHITECT
Oculus

**On October 17, 2016,
the Zoning Commission
approved final action
for Z.C. Case No. 15-16,
but did not approve
any signage shown in
this exhibit.**

Sharon S. Schellin

Secretary to the Zoning Commission

MRP | REALTY

680 Rhode Island Ave. | Washington, DC

Cover Sheet

June 28, 2016 | 0.00

SK+I
ARCHITECTURE

ZONING COMMISSION
District of Columbia
CASE NO. 15-16
EXHIBIT NO. 87D1

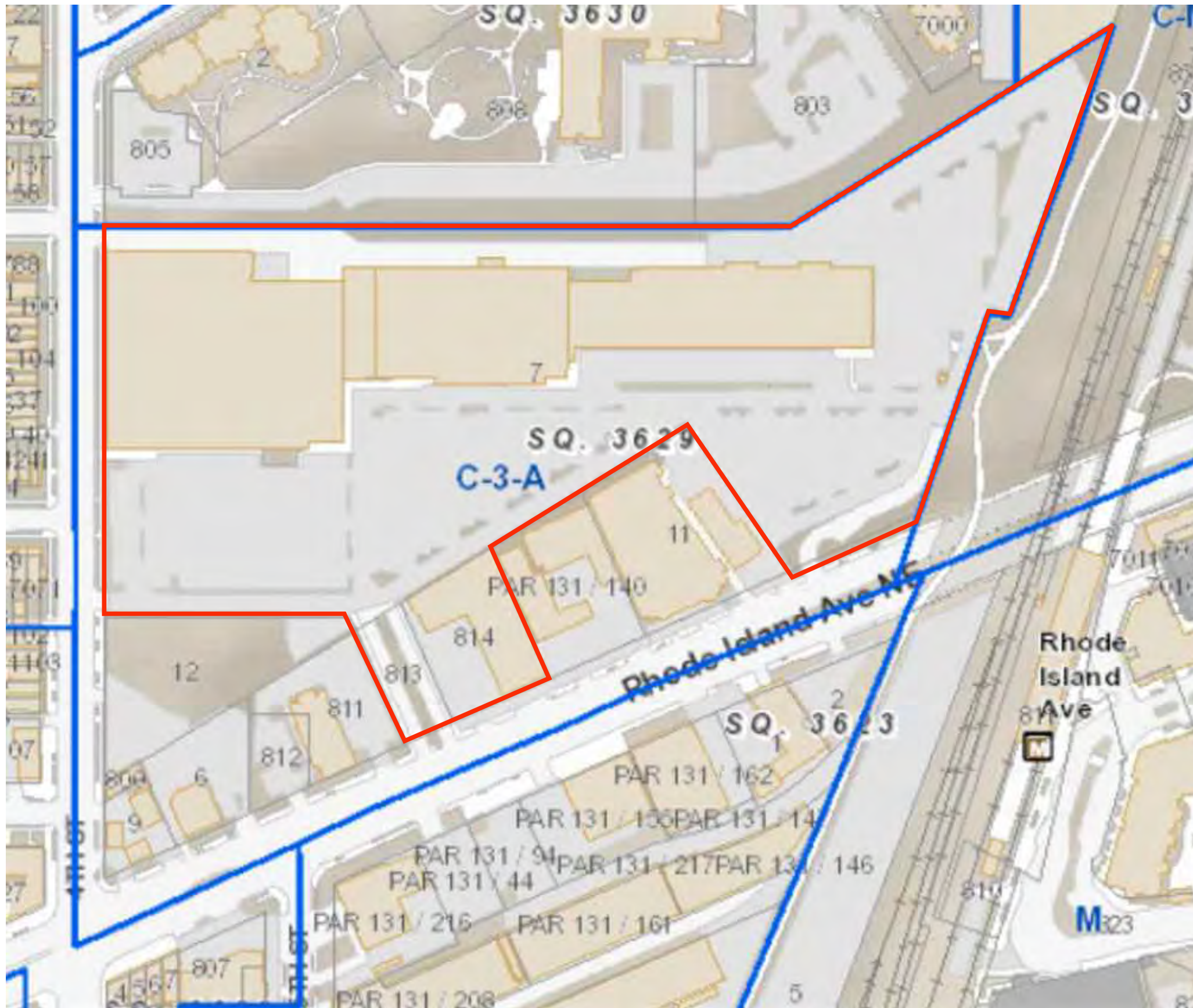



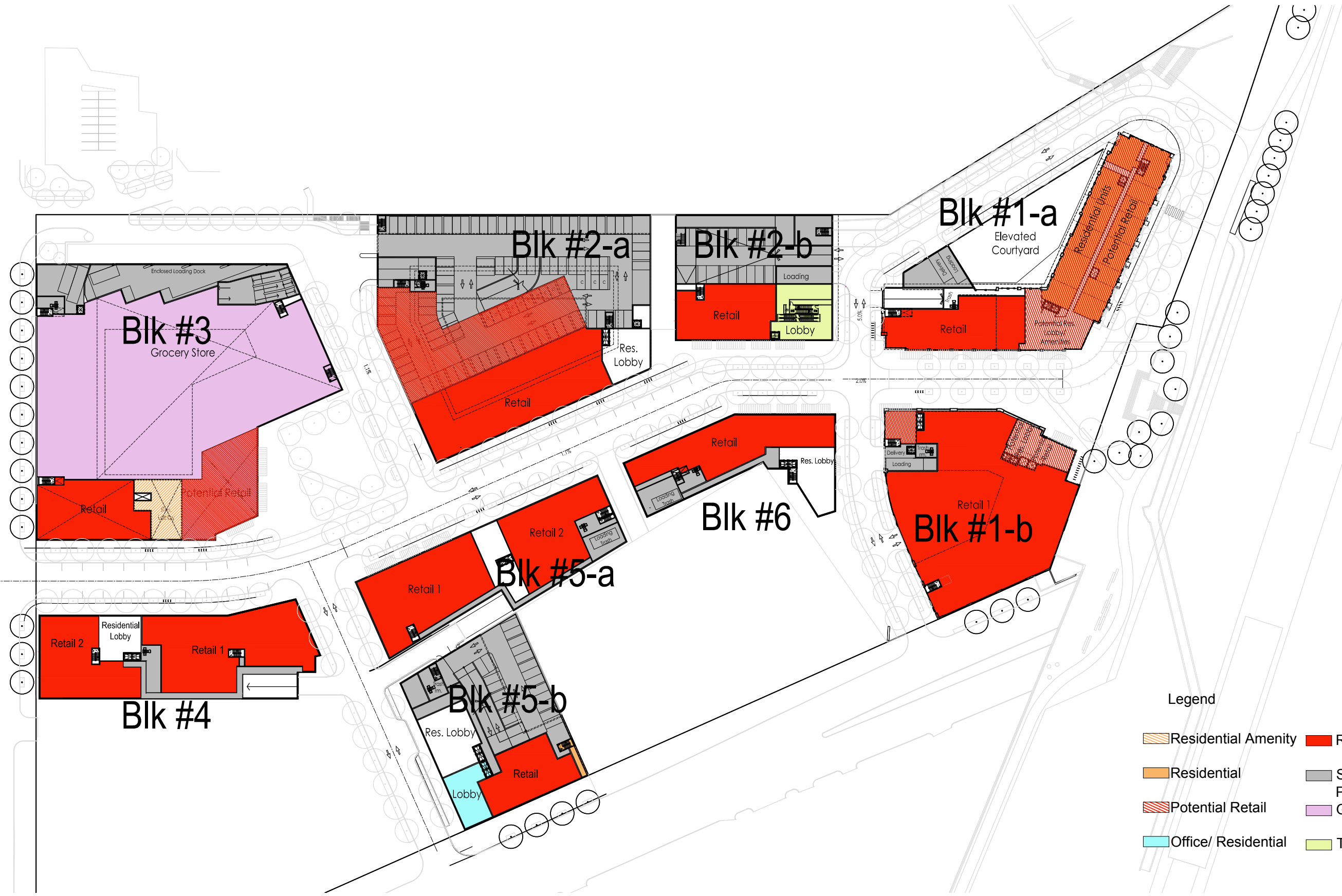

Legend

- Residential Amenity
- Residential
- Potential Retail
- Office/ Residential
- Retail
- Service/ Parking
- Grocery
- Theatre





A. The Vantage Residences



B. Metro Stairs



C. Site from Metro Stairs



D. Rhode Island Avenue Row Apartments



E. 4th and Rhode Island



F. Metro Bridge



G. Existing Retail



H. Greater Mt. Calvary Holy Church



J. Silos on Rhode Island Ave.

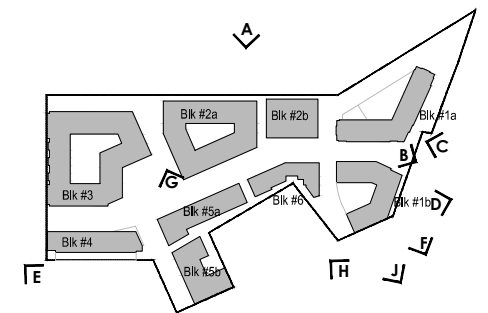

KEY PLAN

MRP REALTY

680 Rhode Island Ave. | Washington, DC

Context

June 28, 2016 | 0.05



A. Metro



B. Metro Bridge



C. Metro

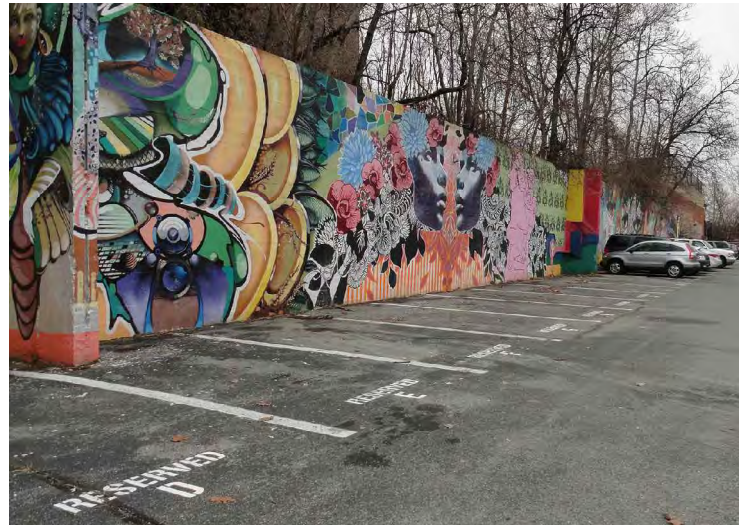

D. Retaining wall

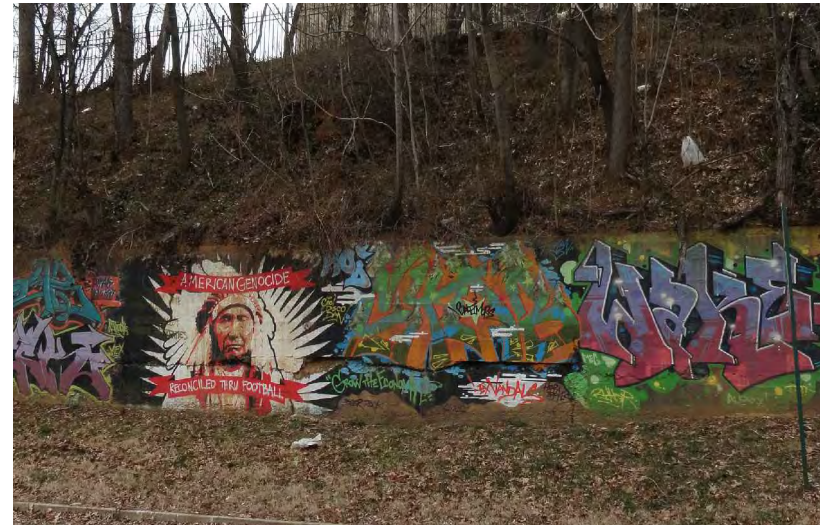

E. Retaining wall



F. Retaining wall



G. Retail

MRP REALTY



H. Adjacent Neighborhood



J. Rhode Island Ave. Underpass

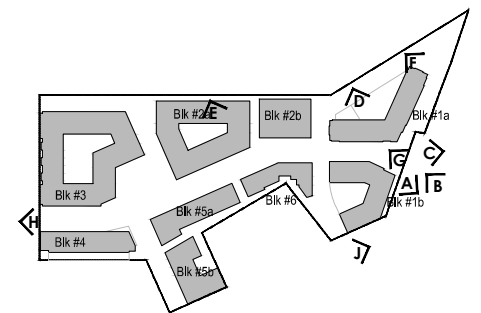

KEY PLAN

680 Rhode Island Ave. | Washington, DC

Context

June 28, 2016

0.06

